

# S-400 SERIES

A FUSION OF  
TIMBER AND  
TECHNICAL  
INNOVATION



CANADIAN RED CEDAR



**SPITFIRE**  
DOORS

MAKE A GRAND ENTRANCE

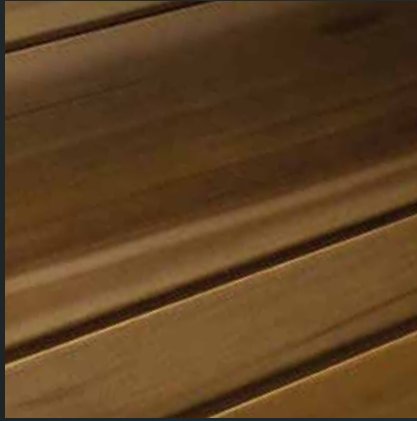



## ENTER THE EXCLUSIVE WORLD OF SPITFIRE DOORS

**Spitfire Doors was established in response to the increasing demand for exclusive, secure, beautifully engineered doors and currently offers the most impressive specifications of any range of high-end residential entrance doors in the UK today.**

A fusion of design and performance, craftsmanship and technical innovation, our new S-400 range combines the sheer beauty and elegance of natural red cedar with a uniquely thermally efficient internal construction.

All designs are exclusive to Spitfire and, in conjunction with our authorised Design Partners, we are supported by comprehensive installation coverage right across the UK and Ireland.



**SPITFIRE  
DOORS**

MAKE A GRAND ENTRANCE

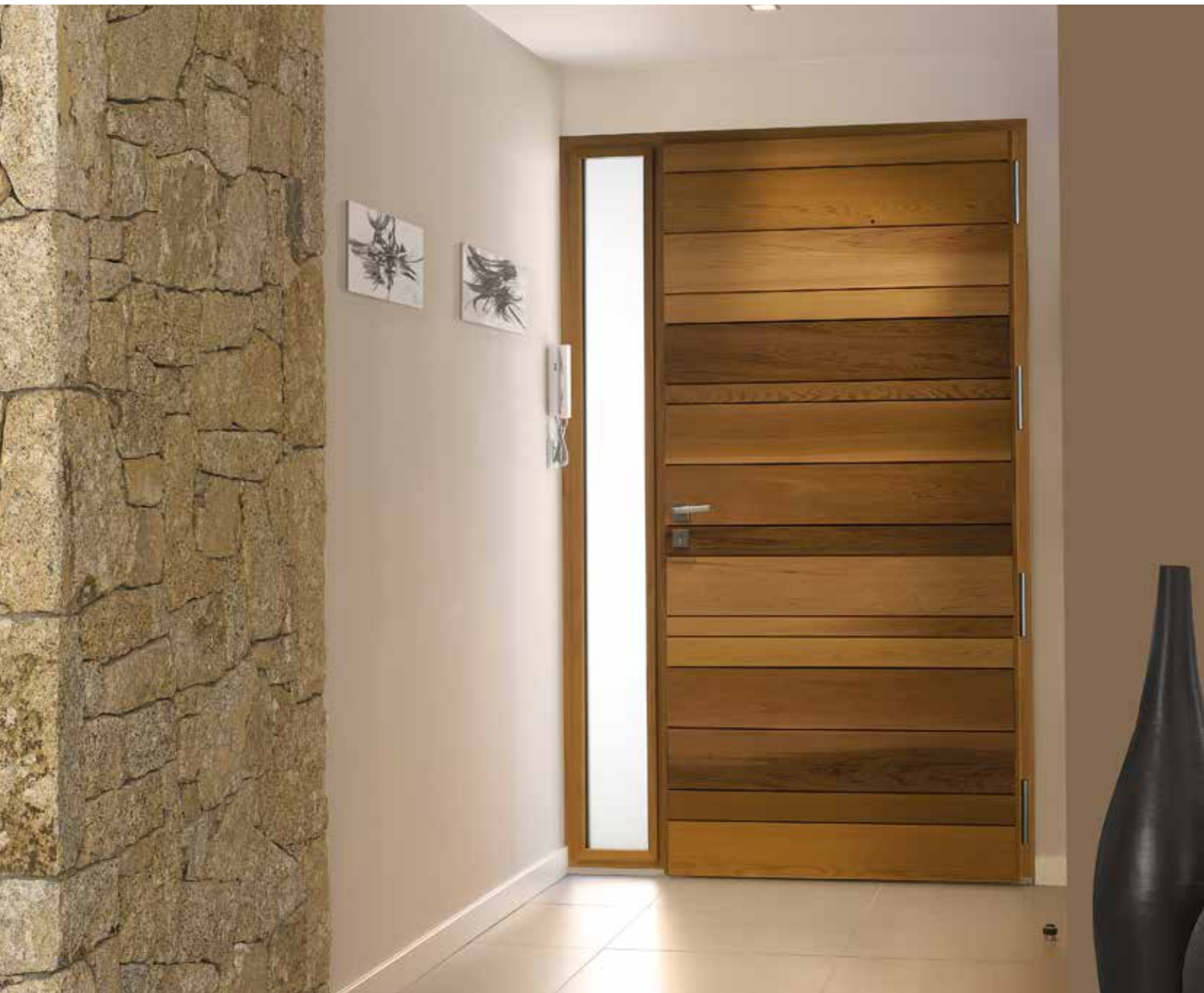

## S-400 A NATURAL CHOICE

For those who love the sheer beauty of natural materials (and who doesn't?), Spitfire's new S-400 series really is the obvious choice. The outerfaces of all our doors are solidly constructed from West Canadian red cedar ('Thuja plicata'), a species justly renowned for the exceptional beauty of its grain, its rarity and great durability.

The beautiful fine grain enables a superbly smooth finish, stained to bring out the natural colour of the wood in all its glory.

The warm glow of the timber is superbly offset by the cool modernity of stainless steel hardware and subtly elegant aesthetic touches such as organic glass insets, wholly exclusive to Spitfire Doors.

While a bespoke care and maintenance kit is also available for easy care.

# 4 UNIQUE HANDLE OPTIONS



**NATIVE 1**  
Lever / Lever Handle



**NATIVE 2**  
Pull Pad / Lever Handle



**Native 1**



**Native 2**



**NATIVE 3**  
Pull Bar / Lever Handle



**NATIVE 4**  
90° Return Pull Bar / Lever Handle



**Native 3**



**Native 4**

# THE BEAUTY OF HIGH PERFORMANCE

Secure and soundproof, our door leaf is a substantial 94mm thick constructed of solid red cedar, fibre board for acoustic insulation and high insulation foam for thermal efficiency, with a thermally broken low threshold @ 20mm high.

# LOOKS GREAT, KEEPS YOU SAFE

With its security barrel and multipoint locks, the S-400 range doesn't just look great; it helps keep you safe too.

There's a wide choice of state-of-the-art, discreetly integrated security options for biometric and keyless entry (simply waft your hand over the sensor to open), automatic keyfob opening or fingerprint recognition (capable of storing up to 100 impressions) and, of course, a physical key for manual override.

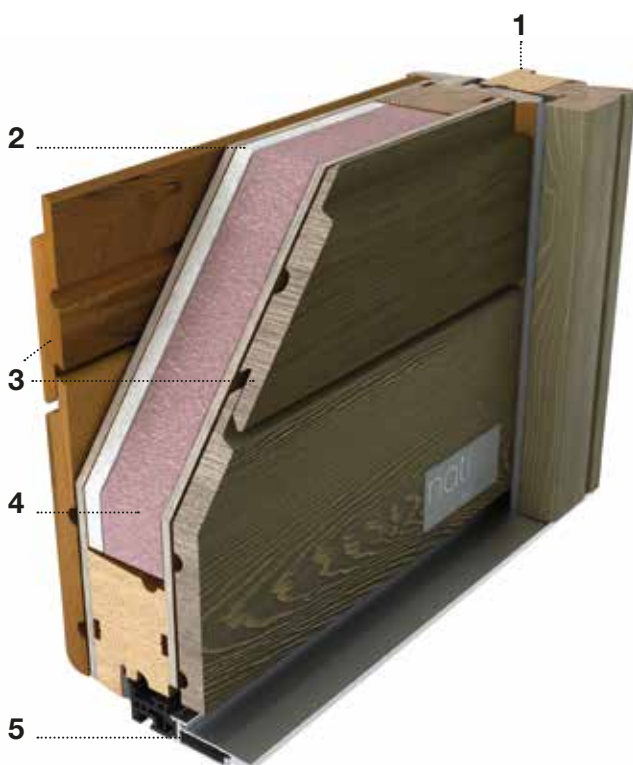

1. SOLID TIMBER SUBFRAME
2. FIBRE BOARD FOR ACOUSTIC INSULATION
3. SOLID RED CEDAR
4. HIGH INSULATION FOAM FOR THERMAL EFFICIENCY
5. THERMALLY BROKEN ALUMINIUM LOW THRESHOLD @ 20MM HIGH



## PROTECTING YOUR POCKET AND THE ENVIRONMENT TOO

The unique construction method provides you with a door that is not only incredibly stable but also offers remarkable thermal qualities and performance with a U value of  $0.77 \text{ W/m}^2\text{K}$ , lower even than the most demanding Passiv Haus standards!

Not only that but the S-400 range is focused on minimal environmental impact with its A rating for the management of those precious natural resources.

All of which means our unique S-400 doors will shield you from high running costs while protecting the environment both inside and outside of your beautiful new front door!



## RUSTIC OR CONTEMPORARY?

The choice is yours. Our S-400 range looks equally fabulous in modern new builds or in beautiful, characterful old barn conversions.





## BEHIND OUR FRONT DOOR

Here you'll find the dedicated Spitfire Doors team led by David Richards who is also Chairman of our sister company, the specialist Schüco aluminium window and bi-folding door manufacturer, KAT.

We are all passionate about quality, value and design, supported by friendly, timely and efficient service. While, like us, our Installation Design Partners are all family owned businesses who, you'll find, are equally dedicated to their trade and, of course, to consummate customer service.



**SPITFIRE**  
DOORS

MAKE A GRAND ENTRANCE



## BIOMETRIC AND KEYLESS ENTRY OPTIONS

Our standard lock is 8-point hook locking with a keywind cylinder. Spitfire S-400 Series entrance doors can also be equipped with discreetly integrated technology which allows you to lock and unlock your door without the use of a key.



4) 2 COMPRESSION PINS - 1 HOOK

5) HANDS FREE SENSOR



6) CENTRAL LOCKING DEADBOLT AND LATCH

7) MOTORIZATION



8) LOW LOCKING POINT FOR SECURITY AND WEATHERING

1) SAFETY SWITCH

2) INTEGRATED TRANSFORMER

3) CONNECTION 240V



# OUR SHOWROOM PARTNERS. SELECTED AND AUTHORISED BY SPITFIRE

You'll be in good hands with our Design Partners. Because Spitfire Doors has appointed a national network of over 30 authorised Design and Installation Partners, many with showrooms, so you can get up close and personal with the Spitfire range for yourself. Our Partners can discuss your requirements, measure up your property and install your beautiful new front door without fuss or mess.



Contact the Spitfire team and we'll put you in touch with your nearest Spitfire Partner.

Spitfire Doors,  
Dogrose Hangar, Unit 1, Queens Avenue,  
Macclesfield, SK10 2BN.

**01625 412 570**

[sales@spitfiredoors.co.uk](mailto:sales@spitfiredoors.co.uk)

[spitfiredoors.co.uk](http://spitfiredoors.co.uk)

Your local Design Partner:



**SPITFIRE  
DOORS**

MAKE A GRAND ENTRANCE